

ELEMENT ASSEMBLY

« MODULE »

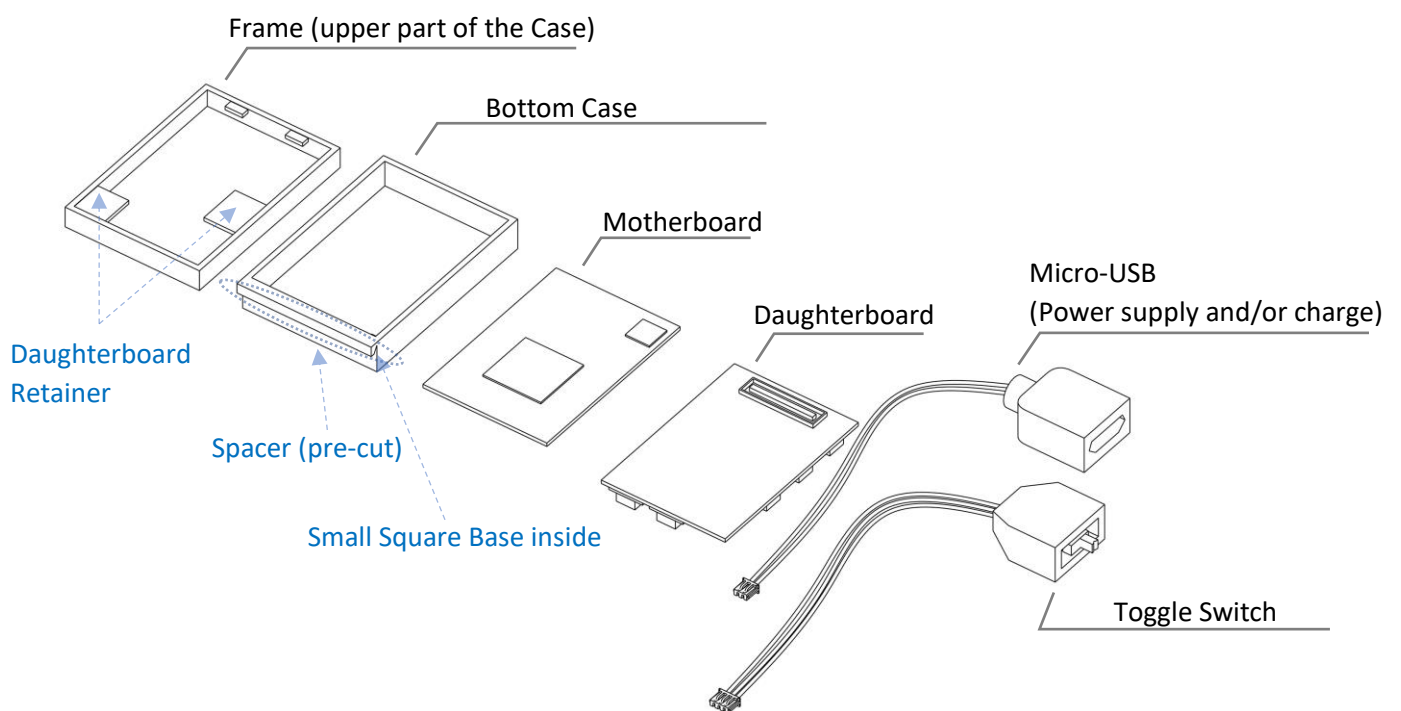

Element « Module » includes:

- 1 x Case: Frame with Daughterboard Retainer / Bottom Case with Square and pre-cut Spacer
- 1 x Motherboard
- 1 x Daughterboard (Static, Static+ or Dynamic according to your choice)
- 1 x Toggle Switch
- 1 x Micro-USB (female socket)

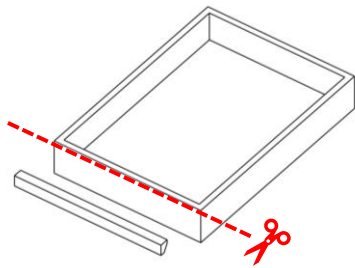

1. Cut out the Spacer, separate it completely from Bottom Case.

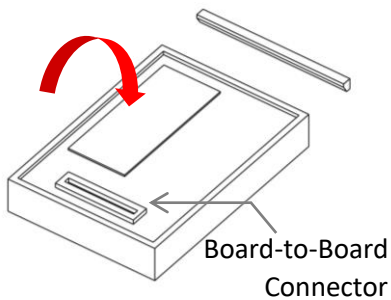

2. Insert the Motherboard into the Bottom Case, connector side up.

! Important

Face the corner free of component of the Motherboard onto the Small Square Base of Bottom Case.

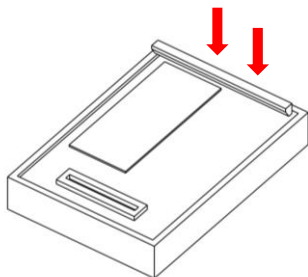

3. Position the Spacer as shown in the illustration. Fix it to the printed circuit board with cyanoacrylate glue, if necessary.

! Important

Apply only a very small amount of glue and do not overflow onto the printed circuit tracks.

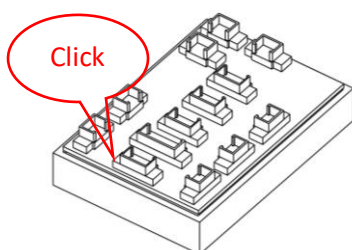

4. Place the Daughterboard on the Motherboard. Ensure that the two boards are firmly connected together by Board-to-Board connectors (female on Daughterboard and male on Motherboard).

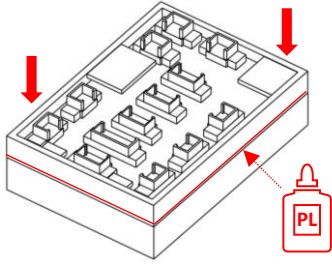

5. Place and glue (plastic cement) the Frame on the Bottom Case to secure a good hold of Module.

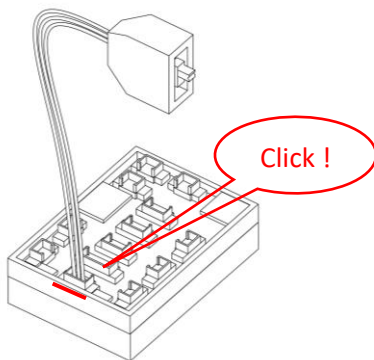

6. Connect Toggle Switch to the Daughterboard (3 pin connector).

! Important

Illustration here represents Dynamic Daughterboard. Please refer to the “Daughterboards Layouts” on our website (User Guides > Elements > Module) to know connector distribution on your Daughterboard.

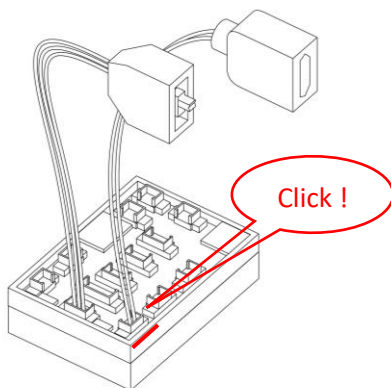

7. Connect Micro-USB to the Daughterboard (2 pin connector).

! Important

Illustration here represents Dynamic Daughterboard. Please refer to the “Daughterboards Layouts” on our website (User Guides > Elements > Module) to know connector distribution on your Daughterboard.