

# ELEMENT ASSEMBLY

## « SMALL MOTOR »

---

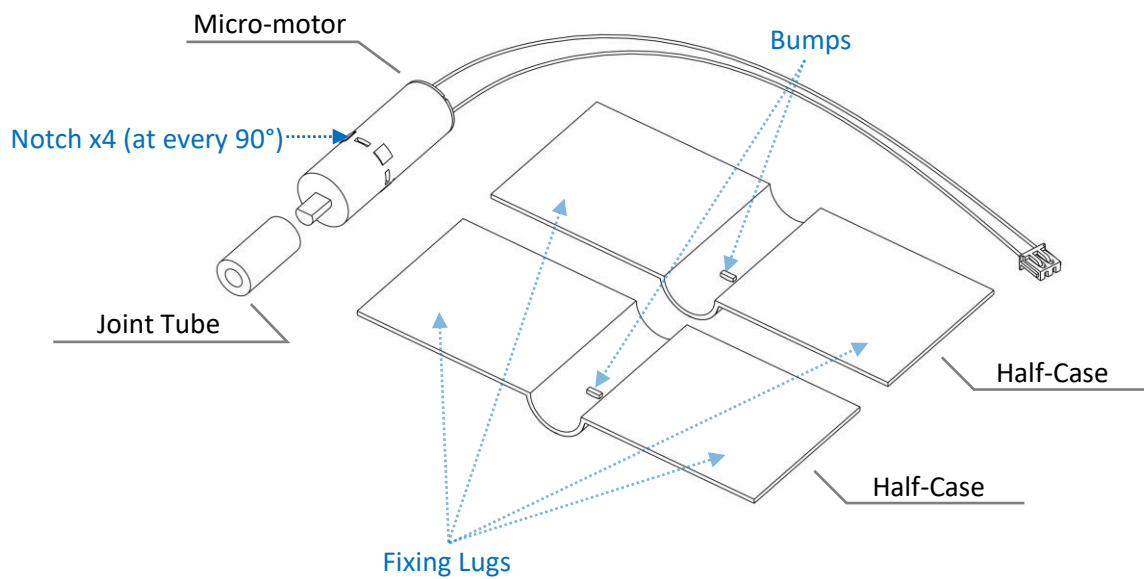

Element « Small Motor » includes:

- 1 x Micro-motor (diameter 6mm, length 17mm – 4 notches at every 90°, « D » shape shaft)
- 1 x Joint Tube (2mm diameter round hole at one end and « D » shape hole at the other end)
- 1 x Motor Case: 2x Plastic Half-Case with a bump

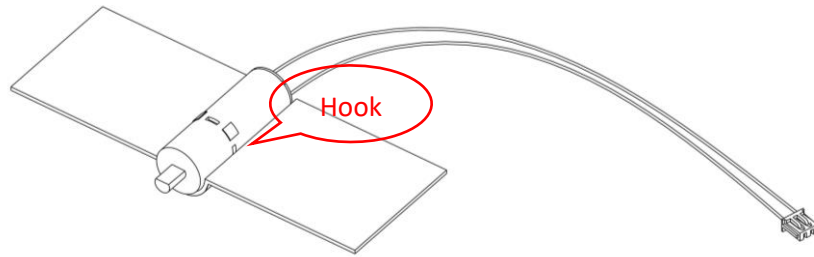

1. Place the Micro-motor in a Half-Case, making sure that the bump on the Half-Case is well positioned in one of the notches of the Micro-motor.

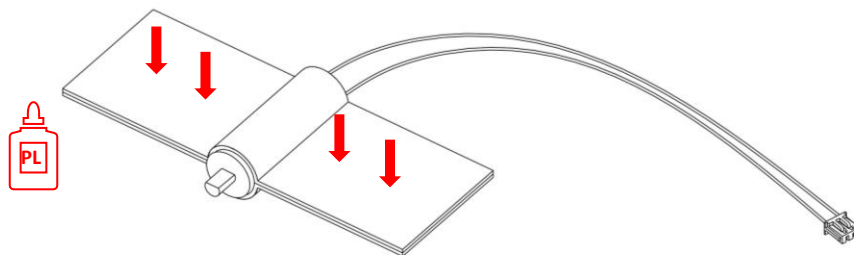

2. Place the other half of the Case and glue (plastic cement) the Fixing Lugs.

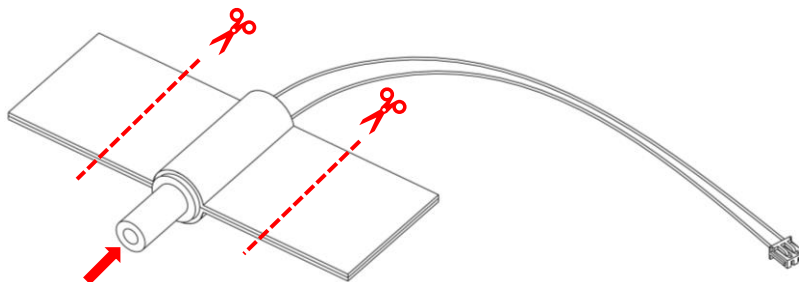

3. Engage the Joint Tube onto the motor shaft without gluing it (D-shape hole toward D-shape motor shaft). Do not push too hard, the motor shaft is fragile.
4. Cut the Fixing Lugs to the desired length to fit the assembly into the model.